

Metropolitan Water Supply: City of Wanneroo

NOTICE OF PROPOSAL TO CONSTRUCT GROUNDWATER RECHARGE BORE SITE - NORTHERN SITE



**RECHARGE BORE SITE PLAN
NORTHERN SITE No.2**
SCALE: ①

ID	DESCRIPTION
①	RECHARGE TANK (6.4m x 6.8m HIGH)
②	RECHARGE PUMPS (20.6m x 11m x 6.2m HIGH)
③	DRAINAGE SUMP
④	LEEDERVILLE RECHARGE BORE (LRB5)
⑤	YARRAGADEE RECHARGE BORE (YRB3)
⑥	LEEDERVILLE MONITORING BORE (LMB5)
⑦	YARRAGADEE MONITORING BORE (YMB3)
⑧	RECHARGE BORE HARDSTAND
⑨	SWITCHROOM (5m x 12.5m x 5.4m HIGH)
⑩	TRANSFORMER (1.6m x 2.3m)
⑪	WPC/WC 22kV SWITCHGEAR PAD

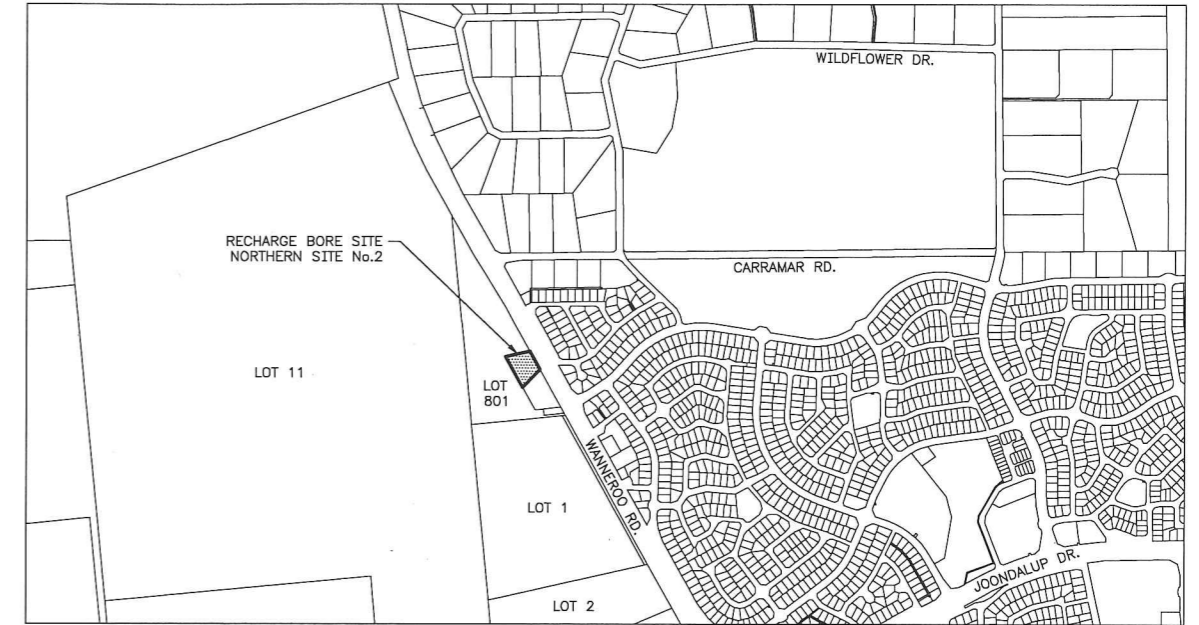

SITE LOCATION PLAN
SCALE: ②

Due to a drying climate, Water Corporation proposes to construct the following groundwater recharge infrastructure in Neerabup to recharge treated water from the Beenyup Advanced Water Recycling Plant into groundwater supplies;

- 500kL recycled water tank
- Electrical switchroom
- Recharge pump building
- Recharge and monitoring bores
- 150kL drainage sump
- Recharge water pipeline

Subject to obtaining all necessary approvals, the proposed works are scheduled to start in February 2018 and will continue for approximately 13 months.

Further information on this work may be obtained by contacting the Project Manager, Mr Ryan Smith, on (08) 9420 2931 during office hours.

Objections to this proposed work will be considered if lodged in writing, addressed to Project Manager, Mr Ryan Smith, PO Box 100, Leederville WA 6902, prior to 12th January 2018.



B	11/2017	SCALE OF SITE PLAN INCREASED TO SHOWN PM CROSSING DRIVEWAY. CONTACT DETAILS, PROJECT DURATION & DATES REVISED.	CJW		DESIGN SURVEY NONE	VERTICAL DATUM NONE	DES CALC I. BURAK DES CHD D. HOWES	NORTH POINT 	RECOMMENDED 13/10/2017 I. BURAK (signed)		INTEGRATED WATER SUPPLY SCHEME IWSS BEENYUP AWRP STAGE 2 - RECHARGE BORE SITE No. 2 PREREQUISITE TO WORKS NOTICE OF PROPOSAL - GENERAL WORKS	ORIGINAL SHEET SIZE A1		
ISSUE	DATE	GRID	REVISION	DRN	REC	APPD	ASCON SURVEY NONE	DES REF	DRN C. WOODHEAD Q.C. CHD P. MIRCO				APPROVED 13/10/2017 D. HOWES (signed)	PROJECT C-W03428